

TOP VIEW

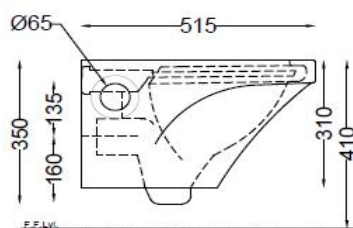

SIDE VIEW

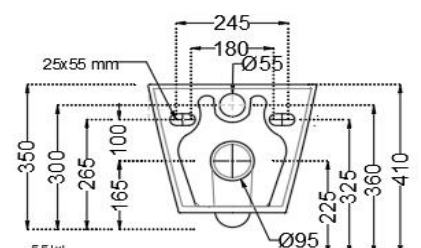

BACK VIEW

General Information

Product Code	STS-WHT-107953SPPSM
Brand	Essco
Colour	White
Type	Wall Mounted WC - P TRAP
Material	Ceramic-Vitreous China (VC)

Product Specification

Product Dimension	360x515x350 mm
Bowl Opening (Inner Dimnesion)	270x335 mm
Product Net Weight	20 kg
Product Gross Weight	24 kg
Packaging Dimension	410x390x530 mm
Outlet	Vertical
Trap Distance	P Trap
Inlet And Outlet Hole Dimension	Internal diameter of inlet hole dia. $\varnothing 55 \pm 3$ mm
	External diameter of outlet hole dia. $\varnothing 100 \pm 5$ mm
Product Feature	Sleek Design With Round Shape PP Soft Close Slim Seat Cover Dual Flushing-3/6 LPF Anti germ glaze

ACCESSORIES PROVIDED

Seat cover	MVS-WHT-101S
Side Cap	ZPS-WHT-SC03
Inlet Outlet Gasket	ZPS-WHT-GK01

ACCESSORIES RECOMMENDATION

Rag bolt	ZPS-SNS-RB01 , ZPS-MST-RB02, ZPS-MST-RB07
Concealed cistern	JCS-WHT-2400S, 2400P, 2400, 2400WS, 2400WP, 2400FS, 2400FP.

CARE AND CLEANING GUIDELINES

- Vitreous china sanitary ware products are fragile in nature and need to be handled with care (to avoid personal injury) at all times during its storage, handling, installation
- The product is heavy and it is recommended that two persons hold it while it is being fixed.
- Carefully inspect the new product for damage before installation.
- Risk of product damage. Over tightening may cause breakage or chipping of vitreous china.
- Risk of external leakage. Do not lift or rock the bowl after placement.
- Always test your cleaning solution on an inconspicuous area on the product before applying it to the entire surface.
- Do not allow cleaners to sit or soak on the product.
- Use a soft, dampened sponge or cloth to clean. Never use abrasive material like a bristle brush or scouring pad.
- Wipe surfaces clean and rinse completely with water immediately after applying cleaners.
- Clean Chrome, stainless steel surfaces once a week. Do not use cleaners containing chloride on chrome, stainless steel. If used, rinse the surface immediately to prevent
- Wherever chrome plating is used on the products, use only warm water to clean and then dry with a soft cloth.

QUALITY MANAGEMENT SYSTEM - ISO 9001



DISCLAIMER: Our every effort has been made to ensure factual accuracy, the information presented subject to changes due to requirements in different sites, markets and/ or countries. All dimensions are in mm (Tolerance ± 5 MM). Jaquar reserves the right to make the necessary amendments at any time without prior notice.